

Bill of Quantities

Schedule-A

S. No.	Est. Qty	Item	Rate in Rupees	Unit	Amount in Rupees
1	2	3	4	5	6
I(A)	4830 Units	<p><u>A)Drinking water system for schools with TDS reduction required to 150- 400 ppm from source water having 400-3000 ppm: Type- I</u> Supplying and fixing of Drinking water system with the set Design, Drawing and Specifications, Cost includes loading, Transportation, supply, unloading charges etc., Erection, Commissioning, Testing including TDS range of the Purified water at the school premises, and all incidental charges, including GST etc., all other taxes and charges for complete finished item of work, with a warranty period of 05(five) years and further extendable AMC for a period of 05(five) years on mutually agreed terms and conditions.</p> <p>Tank overall dimensions: 643.8mmx529.4mmx 1612.2mm (including top cover and leg)</p> <p><u>A] Top water tanks:</u> <u>Raw water tank (40 liters capacity) :</u> Clear size : 224mmx475mmx420mm Outer size : 226.4 mm x 477.4 mm x 421.2mm Openable top cover with strong Hinge: 228.4mmx479.4mmx50mm Floa: 1 No.(Brass/ SS steel) Inlet:SS nipple of 25 mm dia. outlet:SS nipple of 12 mm dia. Drain pipe:SS nipple of 12mm dia Tank made up of 1.20mm thick Stainless-steel sheet 304 grade, openable Top Lid with hinge made up of 1.20mm thick SS sheet 304 grade, Make viz. : Jindal / TATA / Vizag Steel / Salem SAIL.</p>	Rs.70,200/-(Rupees Seventy thousand Two Hundred only)	01 (one System)	

Firm **For Innovative Aqua Systems Pvt. Ltd.,**

Director.

M
22/11

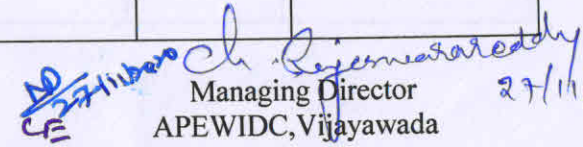
 Managing Director
 APEWIDC, Vijayawada
 27/11/2020

	<p>(2) Pure water tank (60 liters capacity): Clear size : 336mmx475mmx420mm Outer size : 338.4 mm x 477.4 mm x 421.2mm mm Openable Top cover with Hinge : 340.4mmx479.4mmx50mm Float : 1 No.(Brass/ SS steel) Inlet : SS nipple of 25 mm dia. outlet : SS nipple of 12 mm dia. Drain pipe : SS nipple of 12 mm dia. Tank made up of 1.20mm thick Stainless-steel sheet 304 grade Openable Top / Upper Lid with strong Hinge and holder made up of 1.20mm thick SS sheet 304 grade Make viz.: Jindal / TATA / Vizag Steel / Salem SAIL Note: When the water tanks are running out, the pump should sense and start filling tanks automatically.</p> <p>(3) Tank Frame: > The overall Tank frame shall be made with stainless steel tube of size 25 mm x 25 mm x 1.6 mm thickness with all verticals and horizontals and also stiffeners at bottom of raw water tank & pure water tank including bottom supporting sheet of 3 mm thick. > Openable Top cover of 01mm thickness with strong hinge :Top dimension size of tank SS 304 grade (643.8 mm x 529.4mmx37mm) > Locking system for Lid: With SS hinges and pad lock for 01mm thick, SS 304 grade top cover of the above water tank The entire body except back door made up of 01 mm thick SS 304 grade > Embossing letters on Tank : "Nadu -Nedu2020" Tube made up of Stainless steel 304 grade. Make viz.: Jindal / TATA / Vizag Steel / Salem SAIL.</p>			
--	---	--	--	--

	<p>(B) Sink:</p> <ul style="list-style-type: none"> ➤ 4 Nos. of heavy-duty taps connected to stainless steel flexible pipes from pure water tank to foot pedestal and foot pedestal to taps, or better method as approved by the APEWIDC to ensure better water flow pattern. 02 nos of taps on front side and 01 tap each on other two sides. There will not be any tap on the back side of tank as shown in figure. ➤ Sink all three possible sides shall be closed with perforated (05mm dia. holes) stainless steel 304 grade sheet of 1.0 mm thick ➤ Taps shall be fixed at height of 380mm from bottom sink. ➤ Sink bottom shall be made with two layers i.e., one shall be fixed and another one is open able for easy maintenance. ➤ Drainage outlet pipes shall be provided with 25 mm dia. stainless steel 304 grade nipple. <p>(C) Tank Rear side door:</p> <ul style="list-style-type: none"> ➤ Back Door shall be provided in single sheet 304 grade sheet of 1.20mm thickness to the full height of tank with required stiffeners, hinges and locking arrangements. <p>(D) Electrical Input</p> <ul style="list-style-type: none"> ➤ Electrical input with Lock & Key/Socket and pin type joint or other better mode as approved by the APEWIDC. No wires, pipes shall be allowed to hang on to this unit. A separate electrical cord connecting water tank unit with wall mount electrical board. <p>(E) Inlet & Outlet Pipes:</p> <ul style="list-style-type: none"> ➤ Inlet water couple point shall be made to connect from outer source as couple end joint type as to easily removable mode or any other detachable mode, no pipe should be allowed to hang on to the unit and this pipe outlet should reach the unit and have perfect coupling, so that no water leakage can be expected during the raw water tank fill. 			
--	---	--	--	--

	<p>(F)Water Treatment unit with membrane filter(pore size 0.001 microns)UV System (with all necessary connections) shall Fitted in a cabin of the unit. Provision to add filters in future as per requirement to reduce the turbidity TDS to make it potable.</p> <ul style="list-style-type: none"> ➤ UV system with 100 LPH (Make: ALFA / Sukruth / Nexus) ➤ DC Pump - 12 - 24W ➤ booster pump 100-150 GPD or appropriate rating for TDS membrane filter ➤ VOLTAGE-24VDC; AMPS-1.4 to 2.1A; ➤ OPEN FLOW-2.0 to 2.5LPM; ➤ WORKING PRESSURE-75 PSI;SUCTION HEIGHT-2M ➤ TDS Membrane filters(Green Membrane Technology with membrane pore size of 0.001 microns):01(one)number of Membranes are to be used in series. <p>1) 100 gpd size 2112-15 LPH or equal (02)two in number</p> <ul style="list-style-type: none"> ➤ Average purified drinking water output of 20-25 liters per hour at TDS of 150 to 400 ppm, based on feed water TDS from 400-2000 ppm and for range having 2000-3000ppm, the Company shall have to utilize suitable alternate Filtration to Bring down the TDS atleast to 500 ppm. ➤ Micron (Mud) filter-01. (Make: MMP / Pratham/Ionflow/Global absorbent) ➤ Socket - 01 No. ➤ Battery-12V-7ah [two(02) in number with all CHARGEABLE ACEESSORIES] or optimum rating.. ➤ Dual Medial Filter(Activated Carbon Filter) - (Make: ACG / Aqua) ➤ One TDS meter. ➤ The entire tank should be covered with stainless steel sheet of 1.0 mm thick of 304 grade, all-round 03 sides of tank unit including off-sets etc., and the Back door shall be made up of 1.20mm thick SS 304 grade complete with 			
--	--	--	--	--

For Innovative Aqua Systems Pvt. Ltd.,
Firm

Director.

25

A
27/11/20

CE

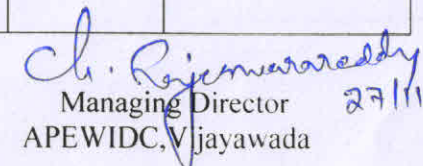

Managing Director
APEWIDC, Vijayawada
27/11/2020.

I(B)	2070 units	<p>stiffeners of 12mm x 12mm x 1.5mm thickness. Top and Back panel shall be openable with locking system. Stainless steel sheets shall be of approved brands viz., Jindal / Salem SAIL.</p> <p>(H) 4 Nos. of 150mm height legs should be provided.</p> <p>(I) The dimensions shown are indicative, however the tolerance limits are $\pm 05\%$ for all dimensions mentioned in figure.</p> <p>(J) Pedal push heavy duty taps as shown in figure shall be provided.</p> <p>(I) The above design is tested through third party fabricator; the intended bidder should understand, prepare a PROTO type, successfully Test for results and participate to ensure above quality parameters.</p> <p>(m) All the pipes used are SS 304 Except the Drain pipe from dispenser, which can be UPVC of 40mm dia.</p> <p>n) COMPRESSIVE WARRANTY: of the entire water purifying system that includes maintenance, repair or replacement of Micron filter and activated Corban filter on Certain Designed/Defined periodicals, even if they are functioning and to replace or repair the UV, Battery, Pumps and Adopters etc. as and when they are not working during the period of five years warranty period and after completion of 05(five) years warranty period, the company have to execute an extendable AMC for a further period of (05) five years on mutual Agreed Terms and Conditions. Further it is appropriate to use battery management system for getting optimum peak power, if possible.</p> <p><u>B) Drinking water system for schools having source water TDS below 400 ppm : Type- I</u></p> <p>Supplying and fixing of Drinking water system with the set Design, Drawing and Specifications, Cost includes loading, Transportation, supply, unloading charges etc., Erection, Commissioning, Testing including TDS range of the Purified water at the school premises, and all incidental charges, including GST etc., all other taxes and charges for complete</p>	Rs.68,400/- (Rupees Sixty Eight thousand Four Hundred Only)		
------	------------	---	---	--	--

Firm For Innovative Aqua Systems Pvt. Ltd.,

Director.

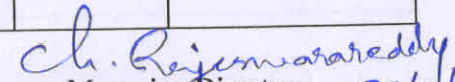
H
CE

Managing Director
APEWIDC, Vijayawada
27/11/2020

	<p>finished item of work, with a warranty period of 05 (five) years and further extendable AMC for a period of 05(five) years on mutually agreed terms and conditions.</p> <p>Tank overall dimensions : 643.8mmx529.4mmx1612.2mm (including top cover and leg)</p> <p><u>A] Top water tanks:</u></p> <p><u>1) Raw water tank (40 liters capacity) :</u> Clear size : 224mmx475mmx420mm Outer size : 226.4 mm x 477.4 mm x 421.2mm Openable top cover with strong Hinge: 228.4mmx479.4mmx50mm Float : 1 No.(Brass/ SS steel) Inlet : SS nipple of 25 mm dia. outlet : SS nipple of 12 mm dia. Drain pipe: SS nipple of 12 mm dia Tank made up of 1.20mm thick Stainless-steel sheet 304 grade, openable Top Lid with hinge made up of 1.20mm thick SS sheet 304 grade, Make viz. : Jindal / TATA / Vizag Steel / Salem SAIL.</p> <p><u>(2) Pure water tank (60 liters capacity):</u> Clear size : 336mmx475mmx420mm Outer size : 338.4 mmx 477.4 mm x 421.2mm Openable Top cover with Hinge : 340.4mmx479.4mmx50mm Float : 1 No.(Brass/ SS steel) Inlet : SS nipple of 25 mm dia. outlet : SS nipple of 12 mm dia. Drain pipe : SS nipple of 12 mm dia. Tank made up of 1.20mm thick Stainless-steel sheet 304 grade Openable Top / Upper Lid with strong Hinge and holder made up of 1.20mm thick SS sheet 304 grade Make viz.: Jindal / TATA / Vizag Steel / Salem SAIL Note: When the water tanks are running out, the pump should sense and start filling tanks automatically.</p> <p><u>(3) Tank Frame :</u> > The overall Tank frame shall be made with stainless steel tube of size 25 mm x 25 mm x 1.6 mm thickness</p>			
--	---	--	--	--

	<p>with all verticals and horizontals and also stiffeners at bottom of raw water tank & pure water tank including bottom supporting sheet of 3 mm thick.</p> <ul style="list-style-type: none"> ➤ Openable Top cover of 01mm thickness with strong hinge :Top dimension size of tank SS 304 grade (643.8 mm x 529.4mmx37mm) ➤ Locking system for Lid: With SS hinges and pad lock for 01mm thick, SS 304 grade top cover of the above water tank <p>The entire body except back door made up of 01 mm thick SS 304 grade</p> <ul style="list-style-type: none"> ➤ Embossing letters on Tank : "Nadu -Nedu2020" ➤ Tube made up of Stainless steel 304 grade. ➤ Make viz. : Jindal / TATA / Vizag Steel / Salem SAIL. <p>(B) Sink:</p> <ul style="list-style-type: none"> ➤ 4 Nos. of heavy-duty taps connected to stainless steel flexible pipes from pure water tank to foot pedestal and foot pedestal to taps, or better method as approved by the APEWIDC to ensure better water flow pattern. 02 nos of taps on front side and 01 tap each on other two sides. There will not be any tap on the back side of tank as shown in figure. ➤ Sink all three possible sides shall be closed with perforated (05mm dia. holes) stainless steel 304 grade sheet of 1.0 mm thick ➤ Taps shall be fixed at height of 380mm from bottom sink. ➤ Sink bottom shall be made with two layers i.e., one shall be fixed and another one is open able for easy maintenance. ➤ Drainage outlet pipes shall be provided with 25 mm dia. stainless steel 304 grade nipple. <p>c) Tank Rear side door:</p> <ul style="list-style-type: none"> ➤ Back Door shall be provided in single sheet 304 grade sheet of 1.20mm thickness to the full height of tank with required stiffeners, hinges and locking arrangements. 			
--	---	--	--	--

Firm For Innovative Aqua Systems Pvt. Ltd.,

Director.

H

AB
CE

Ch. Rajenwarareddy
Managing Director
APEWIDC, Vijayawada
27/11/2020

	<p>(D) Electrical Input</p> <ul style="list-style-type: none"> ➤ Electrical input with Lock & Key/Socket and pin type joint or other better mode as approved by the APEWIDC. No wires, pipes shall be allowed to hang on to this unit. A separate electrical cord connecting water tank unit with wall mount electrical board. <p>(E) Inlet & Outlet Pipes:</p> <ul style="list-style-type: none"> ➤ Inlet water couple point shall be made to connect from outer source as couple end joint type as to easily removable mode or any other detachable mode, no pipe should be allowed to hang on to the unit and this pipe outlet should reach the unit and have perfect coupling, so that no water leakage can be expected during the raw water tank fill. <p>(F) Water Treatment unit with UV System (with all necessary connections) shall Fitted in a cabin of the unit. Provision to add filters in future as per requirement to reduce the turbidity TDS to make it potable.</p> <ul style="list-style-type: none"> ➤ UV system with 100 LPH (Make: ALFA / Sukruth / Nexus) ➤ Dual Media Filter ➤ (Mud) Micron filter-01. (Make: MMP / Pratham Ionflow/Global absorbent) ➤ DC Pump - 12 - 24W ➤ booster pump 0.5 hp ➤ Socket - 01 No. ➤ Battery-12V-7ah [one(01)- in number with all CHARGEABLE ACEESSORIES]optimum rating. ➤ One TDS meter. ➤ The entire tank should be covered with stainless steel sheet of 1.0 mm thick of 304 grade, all-round 03 sides of tank unit including off-sets etc., and the Back door shall be made up of 1.20mm thick SS 304 grade complete with stiffeners of 12mm x 12mm x 1.5mm thickness. Top and Back panel shall be openable with locking system. Stainless steel sheets shall be of approved brands viz., Jindal / Salem SAIL. 			
--	---	--	--	--

Director.

M

CE

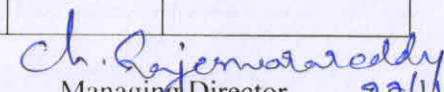
Managing Director
APEWIDC, Vijayawada
27/11/2020

	<p>(H) 4 Nos. of 150mm height legs should be provided.</p> <p>(I) The dimensions shown are indicative, however the tolerance limits are $\pm 05\%$ for all dimensions mentioned in figure.</p> <p>(J) Pedal push heavy duty taps as shown in figure shall be provided.</p> <p>(I) The above design is tested ; but the intended bidder should understand, fabricate, test and participate to ensure above quality parameters.</p> <p>(m) All the pipes used are SS 304 Except the Drain pipe from dispenser , which can be UPVC of 40mm dia.</p> <p>n) COMPRESSIVE WARRANTY: of the entire water purifying system that includes maintenance, repair or replacement of Micron filter and activated Corban filter on Certain Designed/Defined periodicals, even if they are functioning and to replace or repair the UV, Battery, Pumps and Adaptors etc. as and when they are not working during the period of five years warranty period and after completion of 05(five) years warranty period, the company have to execute an extendable AMC for a further period of (05) five years on mutual Agreed Terms and Conditions. Further it is appropriate to use battery management system for getting optimum peak power, if possible.</p> <p>Note: the bidder has to quote lump sum amount for both the above (A) & (B) units, and also to quote rates for each(A) & (B) units separately. The lump sum amount shall be exactly equal to the sum total of (A) & (B) units</p>			
	<p>Grand Total of 1(A) & 1(B) Rs. (Including GST and all other Taxes)</p>			<p>48,06,54,000/-</p>

Firm
For Innovative Aqua Systems Pvt. Ltd.,



Director.

CE

Ch. Rajamurthy
Managing Director 27/11/2020
APEWIDC, Vijayawada

TYPE-I (A)

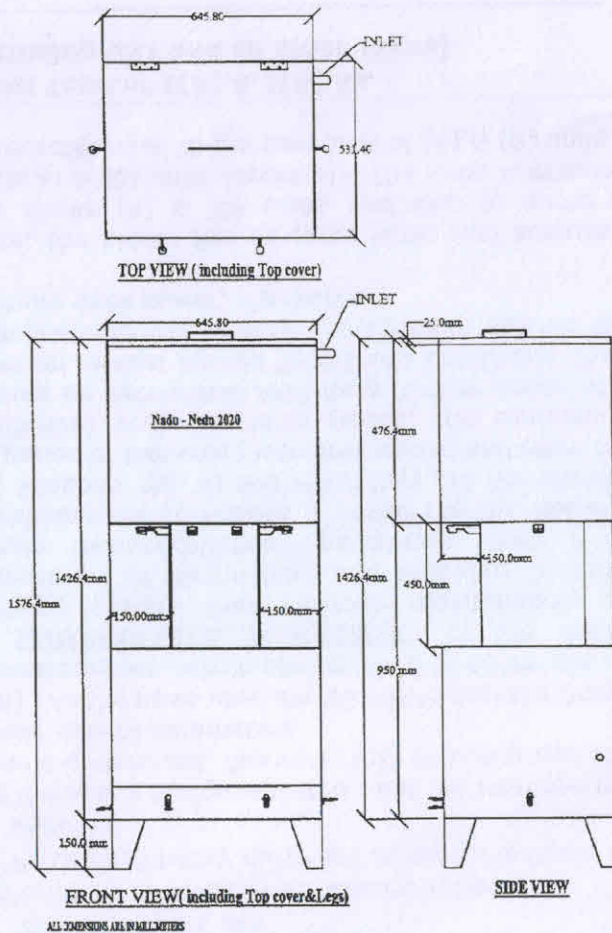
Final Assembly-Fig.1



Notes:

Tank Overall Dimensions : 645.80mm Width X 531.40mm Depth X 1576.4mm Height with Leg & Top cover.

A - Top Cover :

Grade SS304, Thickness 1.0mm.
 SS Hinges Required
 Pad Lock Required

B - Back Door :

Back door shall be provided in single sheet full height of tank with required stiffeners.
 Grade SS304, Thickness 1.20mm.
 SS Hinges and locking arrangement required.

C - Top & Bottom and Middle Closing Cover :

Grade SS304, Thickness 1.0mm.

Embossing Letters required on Top Closing Cover.

D - Sink:

4 No's of Heavy Duty Taps.

Perforated Sheet Grade SS304, Thickness 1.0mm.
 Perforated Sheet 8mm Bolt Required

Taps Shall be fixed at height of 380mm from perforated to Tap center.
 Sink bottom shall be made two layers.

Drayage outlet pipe shall be provided with 25mm Pipe. Grade SS304.

Pure Water Tank : 60 Liters Capacity

Clear Size : 336mm x 475mm x 420mm
 Grade SS304, Thickness 1.20mm.
 Top Cover Required.
 Float Wall Required, (Grade SS/Brass)
 Inlet : SS Nipple Ø 25 mm
 Out let : SS Nipple Ø 12 mm
 Drain Pipe : SS Nipple Ø 12 mm

Raw Water Tank : 40 Liters Capacity

Clear Size : 224mm x 475mm x 420mm
 Grade SS304, Thickness 1.20mm.
 Top Cover Required.
 Float Wall Required, (Grade SS/Brass)
 Inlet : SS Nipple Ø 25 mm
 Out let : SS Nipple Ø 12 mm
 Drain Pipe : SS Nipple Ø 12 mm

Embossing Letter Required : Nadu - Nedu 2020

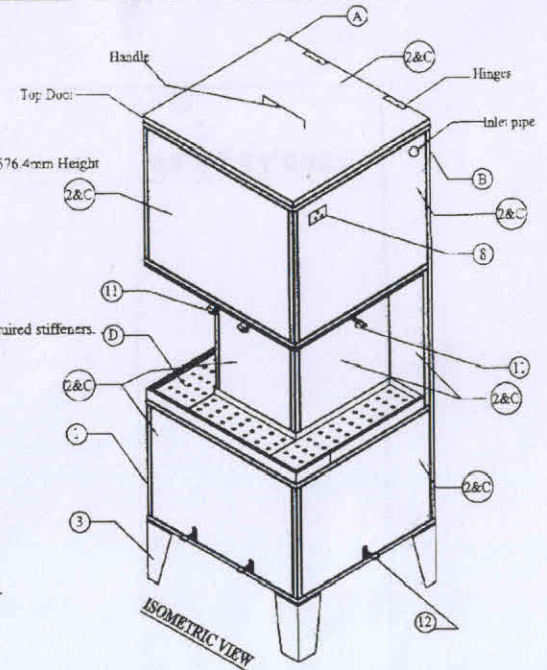

Frame Structure Assembly Details			
Sr.No	Description	Material/Spec	Q.T.Y
1	Frame Structure Assembly	SS304 25x25x3mm	1 Set
2	Top & Bottom and Middle Closing Cover	SS304 ,1.0mm thk	1 Set
3	Heavy Duty legs to withstand 200 kg each		4 No's
4	Uv System	100LPH	1 Set
5	TDS Membrane Filter & Micron Filter		1 Set
6	DC Pump	12-24W	1 Set
7	Booster Pump for ultrafine membrane TDS Filter		1 Set
8	Socket		1 Set
9	Battery	12V-7ah	1 Set
10	Activation Carbon		1 Set
11	Water Taps		4 Set's
12	Foot pedstal		4 Set's

31
 CE
 Managing Director
 APEWIDC, Vijayawada
 27/11/2020

TYPE-I (A) STRUCTURE-Fig.2

Note:

Raw Material S.S.304

Tube of Size : 25mmX25mmX1.6mm Thickness.

Heavy Duty Legs which can with stand 200kg weight.

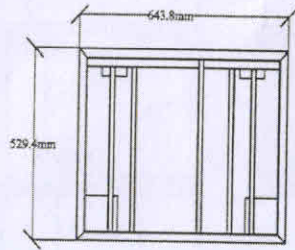

TOP VIEW (excluding Top cover)

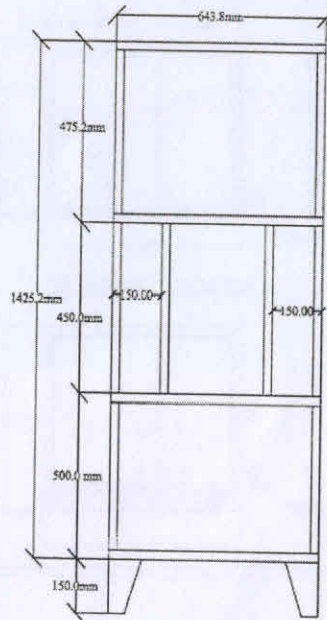

FRONT VIEW

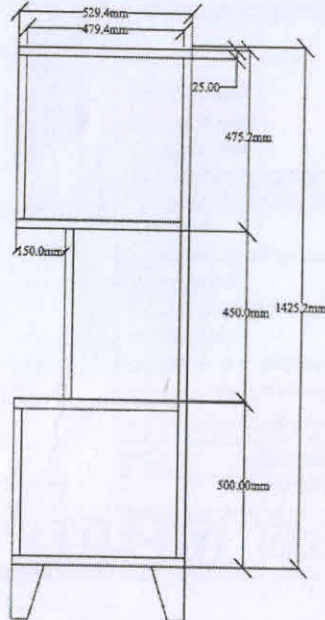

SIDE VIEW

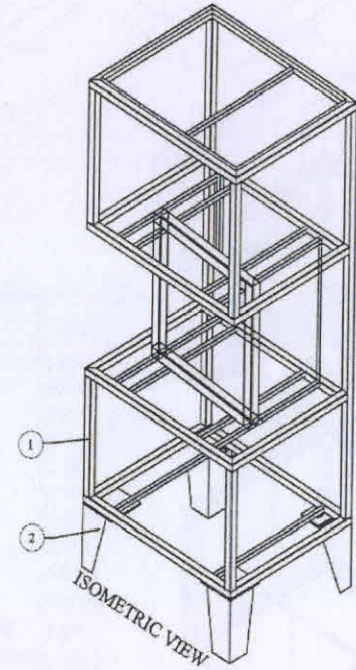

ISOMETRIC VIEW

ALL DIMENSIONS ARE IN MILLIMETERS

Frame Structure Assembly Details			
Sr.No	Description	Material / Spec	Q.T.Y
1	SS Square Tube	SS304 25x25x1.6mm	1 Set
2	Heavy Duty Legs which can with stand 200kg weight.		4 No's

Dr. R. Srinivasan
 Managing Director
 APEWIDD Vijayawada
 27/11/2020

TYPE-I (A) COMPONENTS -Fig.3

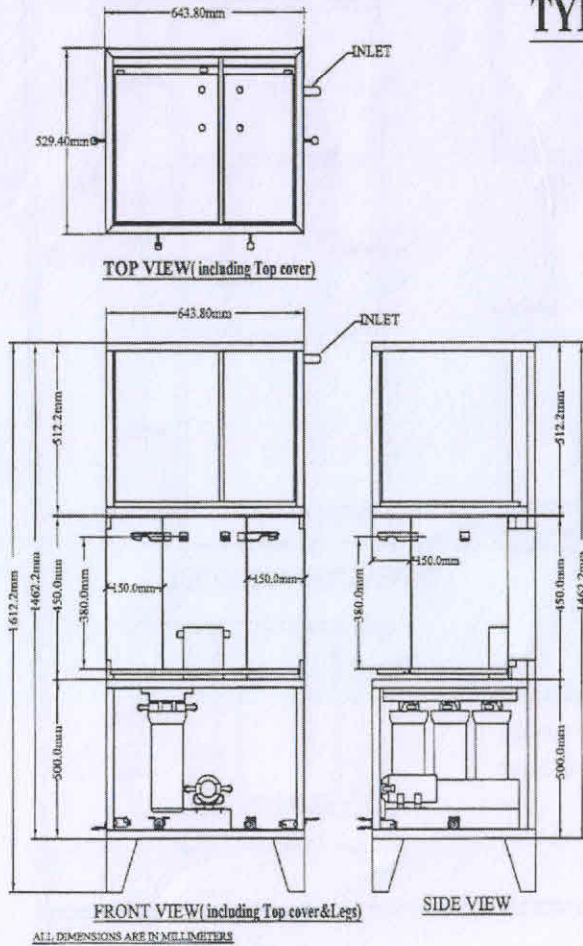

Frame Structure Assembly Details			
Sl.No	Description	Material/Spec	Q.T.Y
1	Frame Structure Assembly	SS304 25x25x1.6mm	1 Set
2	Top & Bottom and Middle Closing Cover	SS304 ,1.0mm thk	1 Set
3	Heavy Duty legs to withstand 200 kg each		4 No's
4	Uv System	100LPH	1 Set
5	TDS Membrane Filter 100gpd size		2 Sets
6	DC Pump	12-24W	1 Set
7	Booster Pump for ultrafine membrane TDS Filter		1 Set
8	Scoket		1 Set
9	Battery (Optimum rating)	12V-7ah	2 Sets
10	Activation Carbon Filter		1 Set
11	Water Taps		4 Set's
12	Foot pedstal		4 Set's
13	Micro filter		1 Set

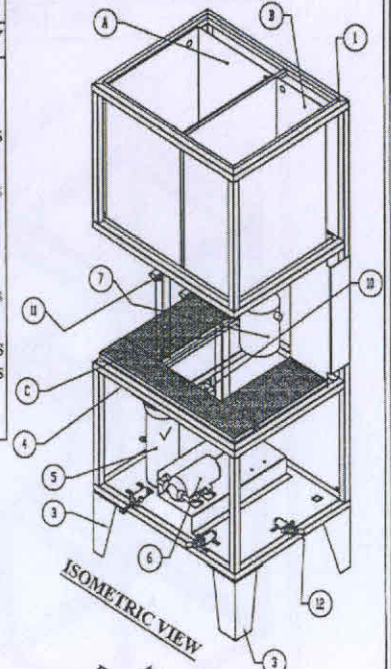

A - Pure Water Tank : 60 Liters Capacity

Clear Size : 336mm x 475mm x 420mm
 Grade SS304, Thickness 1.20mm.
 Top Cover Required.
 Float Wall Required ,(Grade SS/Brass)
 Inlet : SS Nipple Ø 25mm.
 Out let : SS Nipple Ø 12mm.
 Drain Pipe : SS Nipple Ø 12mm.

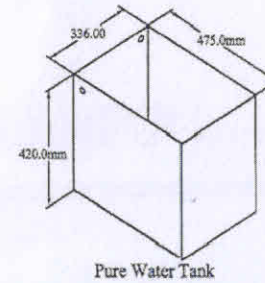

B - Raw Water Tank : 40 Liters Capacity

Clear Size : 225mm x 475mm x 420mm
 Grade SS304, Thickness 1.20mm.
 Top Cover Required.
 Float Wall Required ,(Grade SS/Brass)
 Inlet : SS Nipple Ø 25mm.
 Out let : SS Nipple Ø 12mm.
 Drain Pipe : SS Nipple Ø 12mm.

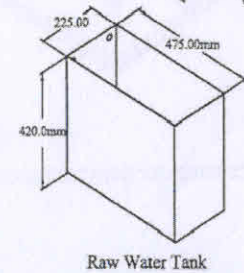

C-Perforated Sheet with Ø 5 mm holes

Handwritten signatures and notes:
 Managing Director
 APEW/IDC, Vijayawada
 27/11/2020

TYPE-I (B)

Final Assembly-Fig.1

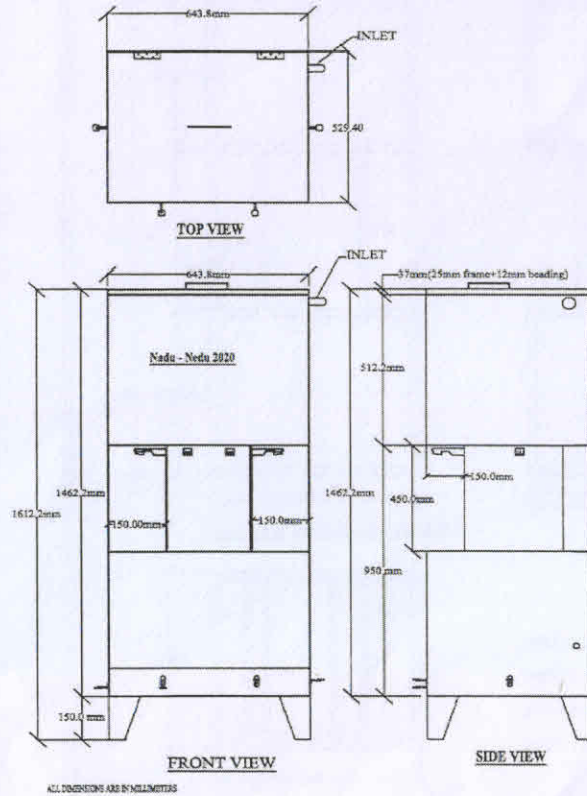

Notes:

- 1) Tank Overall Dimensions : 643.80mm Width X 529.40mm Depth X 1612.2mm Height with Leg & Top cover .
- 2) Feed water having TDS ≤ 400 ppm.

A - Top Cover :

Grade SS304, Thickness 1.0mm.
SS Hinges Required
Pad Lock Required

B - Back Door :

Back door shall be provided in single sheet full height of tank with required stiffeners.
Grade SS304, Thickness 1.20mm.
SS Hinges and locking arrangement required.

C - Top & Bottom and Middle Closing Cover :

Grade SS304, Thickness 1.0mm.

Embossing Letters required on Top Closing Cover.

D - Sink :

4 No's of Heavy Duty Taps.

Perforated Sheet Grade SS304, Thickness 1.0mm.
Perforated Sheet 8mm Size Required.

Taps Shall be fixed at height of 380mm from perforated to Tap center.
Sink bottom shall be made two layers.

Drayage outlet pipe shall be provided with Ø 25mm Pipe Grade SS304

Pure Water Tank : 60 Liters Capacity

Clear Size : 336mm x 475mm x 420mm
Grade SS304, Thickness 1.20mm.
Top Cover Required.
Float Wall Required. (Grade SS/Brass)
Inlet : SS Nipple Ø 25 mm
Out let : SS Nipple Ø 12 mm
Drain Pipe : SS Nipple Ø 12 mm

Raw Water Tank : 40 Liters Capacity

Clear Size : 224mm x 475mm x 420mm
Grade SS304, Thickness 1.20mm.
Top Cover Required.
Float Wall Required. (Grade SS/Brass)
Inlet : SS Nipple Ø 25 mm
Out let : SS Nipple Ø 12 mm
Drain Pipe : SS Nipple Ø 12 mm

Embossing Letter Required : Nadu - Nedu 2020

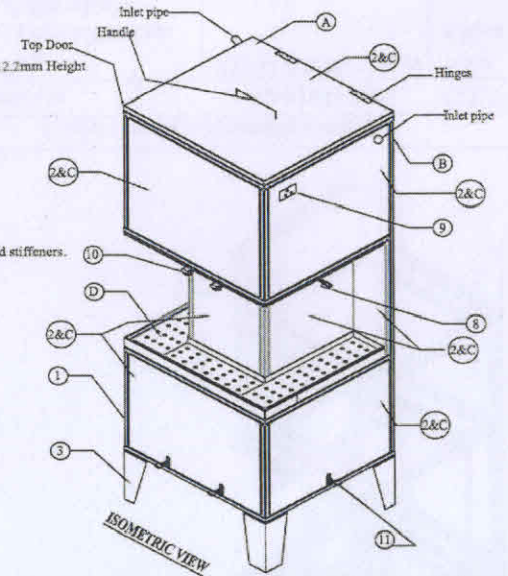

Frame Structure Assembly Details			
Sl.No	Description	Material/Spec	Q.T.Y
1	Frame Structure Assembly	SS304 25x25x1.6mm	1 Set
2	Top & Bottom and Middle Closing Cover	SS304 ,1.0mm thk	1 Set
3	Heavy Duty legs to withstand 200 kg each		4 No's
4	Uv System	100LPH	1 Set
5	(Mud) Micron Filter		1 Set
6	DC Pump	12-24W	1 Set
7	Booster Pump	300 gpd	1 Set
8	Battery-12V-7ah optimum rating. One TDS meter		1 Set
9	Socket		1 Set
10	Water Taps		4 Set's
11	Foot pedstal		4 Set's
12	Activation Carbon Filter		1 Set

Handwritten signatures and notes:
 CE
 Managing Director
 APEWIDC, Vijayawada
 27/11/2020

Dr. Rajenaraj Reddy
Managing Director
APE WIDC, Vijayawada
27/11/2020

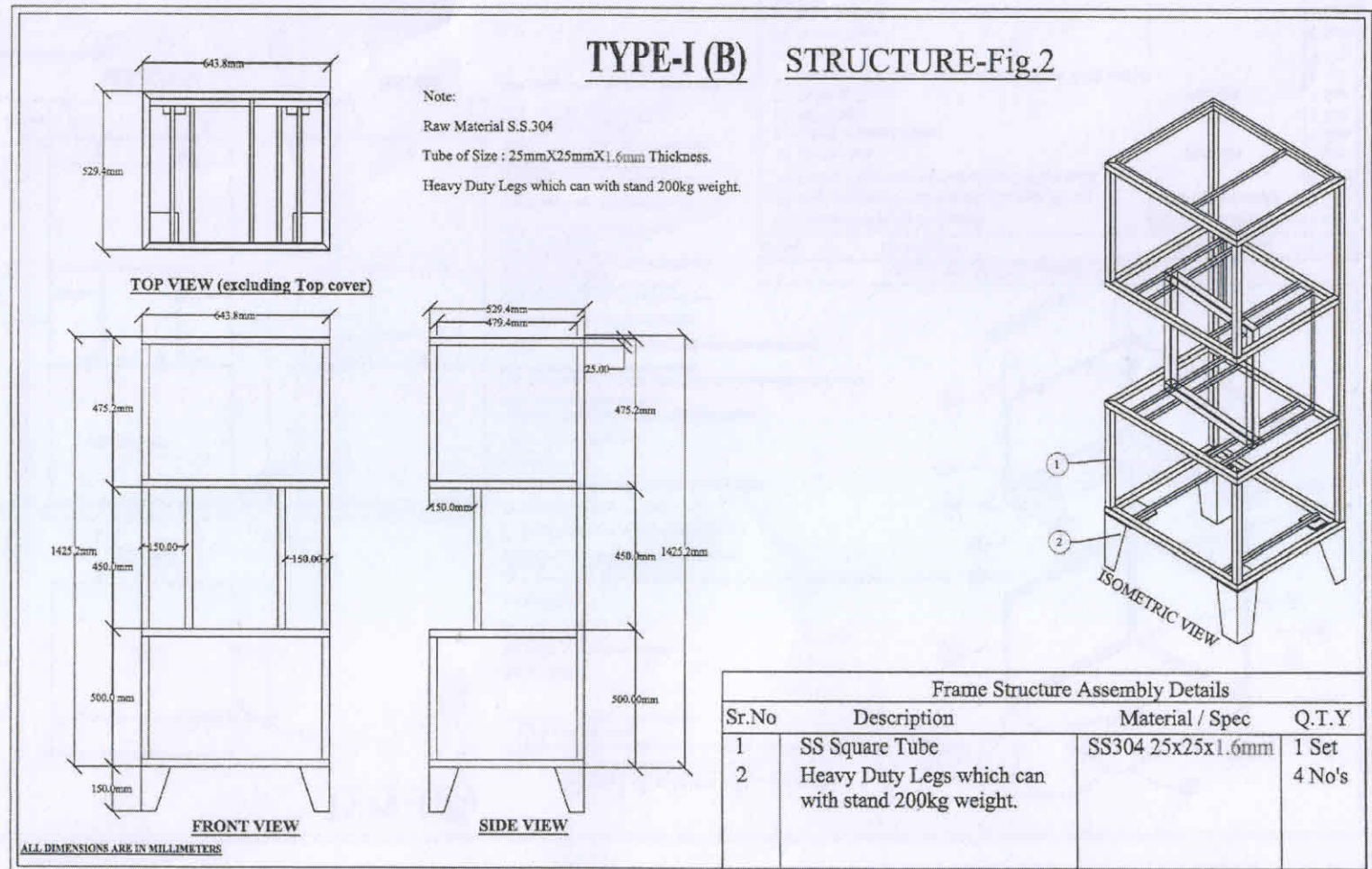

Firm
 For Innovative Aqua Systems Pvt. Ltd.,
 Director.

TYPE-I (B) COMPONENTS -Fig.3

Frame Structure Assembly Details			
Sl.No	Description	Material/Spec	Q.T.Y
1	Frame Structure Assembly	SS304 25x25x1.6mm	1 Set
2	Top & Bottom and Middle Closing Cover	SS304 ,1.0mm thk	1 Set
3	Heavy Duty legs to withstand 200 kg each		4 No's
4	Uv System	100LPH	1 Set
5	(Mud) Micron Filter		1 Set
6	DC Pump	12-24W	1 Set
7	Booster Pump	300 gpd	1 Set
8	Battery-12V-7ah optimum rating,One TDS meter		1 Set
9	Socket		1 Set
10	Water Taps		4 Set's
11	Foot pedestal		4 Set's
12	Activation Carbon Filter		1 Set

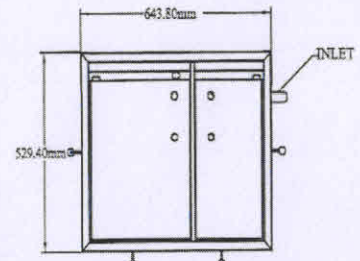

TOP VIEW (including Top cover)

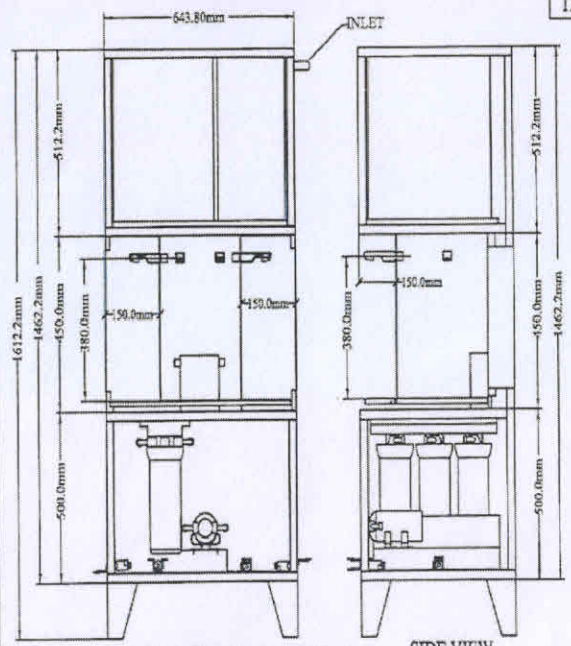

FRONT VIEW (including Top cover & Legs)

SIDE VIEW

A - Pure Water Tank : 60 Liters Capacity

Clear Size : 336mm x 475mm x 420mm
 Grade SS304, Thickness 1.20mm.
 Top Cover Required.
 Float Wall Required ,(Grade SS/Brass)
 Inlet : SS Nipple Ø 25mm.
 Out let : SS Nipple Ø 12mm.
 Drain Pipe : SS Nipple Ø 12mm.

B - Raw Water Tank : 40 Liters Capacity

Clear Size : 225mm x 475mm x 420mm
 Grade SS304, Thickness 1.20mm.
 Top Cover Required.
 Float Wall Required ,(Grade SS/Brass)
 Inlet : SS Nipple Ø 25mm.
 Out let : SS Nipple Ø 12mm.
 Drain Pipe : SS Nipple Ø 12mm.

C-Perforated Sheet with Ø 5 mm holes

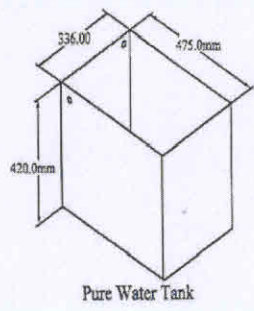
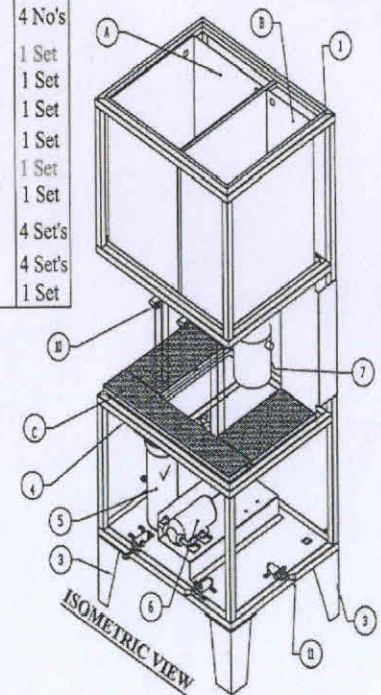

Pure Water Tank

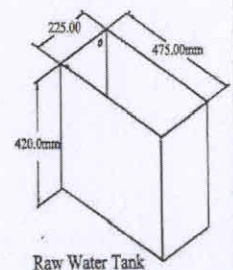

Raw Water Tank

ALL DIMENSIONS ARE IN MILLIMETERS

H
 Director
 Managing Director
 APEWIDC, Vijayawada
 27/11/2022